

PLANTA
ESCALA 1:1.000

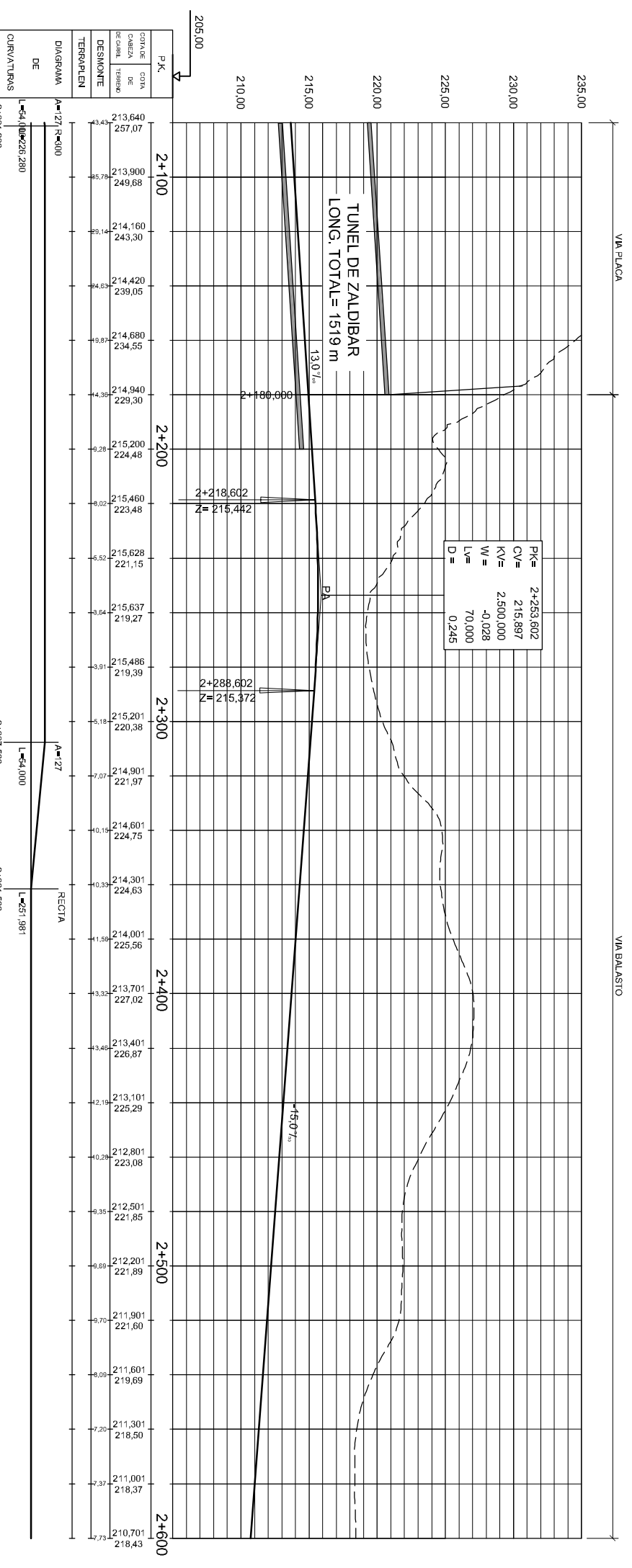

PERFIL LONGITUDINAL
ESCALA H: 1:1.000
V: 1: 200

PK.	213.640	213.900	214.160	214.420	214.680	214.940	215.200	215.460	215.720	215.980	216.240	216.500	216.760	217.020	217.280	217.540	217.800	218.060	218.320	218.580	218.840	219.100	219.360	219.620	219.880	220.140	220.400	220.660	220.920	221.180	221.440	221.700	221.960	222.220	222.480	222.740	223.000	223.260	223.520	223.780	224.040	224.300	224.560	224.820	225.080	225.340	225.600	225.860	226.120	226.380	226.640	226.900	227.160	227.420	227.680	227.940	228.200	228.460	228.720	228.980	229.240	229.500	229.760	230.020	230.280	230.540	230.800	231.060	231.320	231.580	231.840	232.100	232.360	232.620	232.880	233.140	233.400	233.660	233.920	234.180	234.440	234.700	234.960	235.220	235.480	235.740	236.000
-----	---------	---------	---------	---------	---------	---------	---------	---------	---------	---------	---------	---------	---------	---------	---------	---------	---------	---------	---------	---------	---------	---------	---------	---------	---------	---------	---------	---------	---------	---------	---------	---------	---------	---------	---------	---------	---------	---------	---------	---------	---------	---------	---------	---------	---------	---------	---------	---------	---------	---------	---------	---------	---------	---------	---------	---------	---------	---------	---------	---------	---------	---------	---------	---------	---------	---------	---------	---------	---------	---------	---------	---------	---------	---------	---------	---------	---------	---------	---------	---------	---------	---------	---------	---------	---------	---------	---------

PK=	2+253,602
KV=	215,987
KV=	2.500,000
W=	-0,028
LW=	70,000
D=	0,245

CONTR. CIVIL	213,640	257,07
CONTR. FERROVIARIO	213,900	249,68
DESARROLLO	214,160	243,30
TERMINAL	214,420	239,05
DIAGRAMA	214,680	234,55
DE	214,940	229,30
CURVATURAS	215,200	224,48
	215,460	223,48
	215,720	223,48
	215,980	221,15
	216,240	219,27
	216,500	219,39
	216,760	220,38
	217,020	221,97
	217,280	224,75
	217,540	224,63
	217,800	225,56
	218,060	227,02
	218,320	227,02
	218,580	226,87
	218,840	225,29
	219,100	225,08
	219,360	221,85
	219,620	221,89
	219,880	221,60
	220,140	219,69
	220,400	218,50
	220,660	218,37
	220,920	218,37
	221,180	218,43

A=127	R=300
L=54,000	R=280
2+081,286	

A=127	R=300
L=54,000	
2+307,566	

A=127	R=300
L=54,000	
2+561,981	

A=127	R=300
L=54,000	
2+561,981	

A=127	R=300
L=54,000	
2+561,981	

A=127	R=300
L=54,000	
2+561,981	

A=127	R=300
L=54,000	
2+561,981	

A=127	R=300
L=54,000	
2+561,981	

A=127	R=300
L=54,000	
2+561,981	

A=127	R=300
L=54,000	
2+561,981	

A=127	R=300
L=54,000	
2+561,981	

A=127	R=300
L=54,000	
2+561,981	

A=127	R=300
L=54,000	
2+561,981	

A=127	R=300
L=54,000	
2+561,981	

A=127	R=300
L=54,000	
2+561,981	

A=127	R=300
L=54,000	
2+561,981	

A=127	R=300
L=54,000	
2+561,981	

A=127	R=300
L=54,000	
2+561,981	

A=127	R=300
L=54,000	
2+561,981	

A=127	R=300
L=54,000	
2+561,981	

A=127	R=300
L=54,000	
2+561,981	

A=127	R=300
L=54,000	
2+561,981	

A=127	R=300
L=54,000	
2+561,981	

A=127	R=300
L=54,000	
2+561,981	

A=127	R=300
L=54,000	
2+561,981	

A=127	R=300
L=54,000	
2+561,981	

A=127	R=300
L=54,000	
2+561,981	

OHARRAK:
NOTAS:
- FUTURA VARIANTE DE ENLACE EN DESARROLLO.

DESIGNO N°	TIPO DE APARATO	SECCION TIPO
1	DSM-C-54E1-300-1-11-CC-I-TC	BALASTO
2	DSM-C-54E1-300-1-11-CC-I-TC	BALASTO
E3/4	ESM-C(PAD)-54E1-300-1-14-GR-I-3200	PLACA
5	DSM-C(PAD)-54E1-380-1-8-S	PLACA
6	DSM-C-54E1-300-1-11-CC-D-TC	BALASTO

NOTA:
- EL DESVIO 2 PERTENECE AL DESVIO PROVISIONAL DE ZALDIBAR Y EL E3/4 PERTENECE A LA FASE 2.

